

PERMIT

CITY OF NAPOLEON, OHIO — DEPT. OF BUILDING & ZONING
255 W. Riverview Avenue, Napoleon, Ohio 43545 (419) 592-4010

Permit No. 472 Date July 20, 1982
 Job Location 925 Welsted Valuation \$ 160.00
 Owner Mary Lou Winover Address Malinta, Ohio
 Contractor Lonnie Winover Name Address Telephone No.
 Address 925 Welsted, Napoleon, Ohio

Electric Contractor _____
 Plumbing Contractor _____
 Mechanical Contractor _____

This permit is issued for work described in the plans, specifications, and/or application submitted, as approved by the Building Commissioner of the City of Napoleon, Ohio. Work shall conform to all pertinent construction and land use Codes and Ordinances.

Work Information:

Residential Commercial _____ Industrial _____
No. dwelling units
 New Construction _____ Addition _____ Remodel _____
 Brief Description of Work Move building and pour footer

ISSUED BY Richard J. Hagman DEPT. OF BUILDING & ZONING
Building Official

It is the owners or contractors responsibility to call the Building Department for the following (x) inspections:

- _____ Footing excavation prior to placing concrete.
- _____ Footing drains and foundation prior to backfill.
- _____ Prepared sub-grade prior to placing concrete floor slab.
- _____ Sanitary sewer
- _____ Rough-in electrical, plumbing and service framing prior to installing wall board.
- _____ Final electrical, plumbing and heating.
- _____ Final building inspection, prior to occupancy.

Permit is not valid until all fees are paid in full, and shall be void if work is not started within six months of date above.

PERMIT & FEES

Building Permit	\$ <u>3.00</u>
Electrical Permit	\$ _____
Plumbing Permit	\$ _____
Mechanical Permit	\$ _____
Demolition Permit	\$ _____
Zoning Permit	\$ _____
Sign Permit	\$ _____
Water Tap	\$ _____
Sewer Tap	\$ _____
Temp. Elec.	\$ _____
Other	\$ _____

TOTAL FEES \$ 3.00
 LESS FEES PAID \$ -0-
 BALANCE DUE \$ 3.00

PAID

JUL 21 1982

CITY OF NAPOLEON

PERMIT

CITY OF NAPOLEON, OHIO — DEPT. OF BUILDING & ZONING
255 W. Riverview Avenue, Napoleon, Ohio 43545 (419) 592-4010

Permit No. 472 Date July 20, 1982
Job Location 925 Welsted Valuation \$ 160.00
Owner Mary Lou Winover Address Malinta, Ohio
Contractor Lonnie Winover Name Address Malinta, Ohio
Address 925 Welsted, Napoleon, Ohio Telephone No. _____
Electric Contractor _____
Plumbing Contractor _____
Mechanical Contractor _____

This permit is issued for work described in the plans, specifications, and/or application submitted, as approved by the Building Commissioner of the City of Napoleon, Ohio. Work shall conform to all pertinent construction and land use Codes and Ordinances.

Work Information:

Residential Commercial _____ Industrial _____
New Construction _____ Addition _____ Remodel _____
Brief Description of Work Move building and pour footer

ISSUED BY _____ DEPT. OF BUILDING & ZONING

It is the owners or contractors responsibility to call the Building Department for the following (X) inspections:

- Footing excavation prior to placing concrete.
- Footing drains and foundation prior to backfill.
- Prepared sub-grade prior to placing concrete floor slab.
- Sanitary sewer
- Rough-in electrical, plumbing and service framing prior to installing wall board.
- Final electrical, plumbing and heating.
- Final building inspection, prior to occupancy.

PERMIT & FEES

Building Permit	\$ <u>3.00</u>
Electrical Permit	\$ _____
Plumbing Permit	\$ _____
Mechanical Permit	\$ _____
Demolition Permit	\$ _____
Zoning Permit	\$ _____
Sign Permit	\$ _____
Water Tap	\$ _____
Sewer Tap	\$ _____
Temp. Elec.	\$ _____
Other _____	\$ _____
TOTAL FEES	\$ <u>3.00</u>
LESS FEES PAID	\$ <u>-0-</u>
BALANCE DUE	\$ <u>3.00</u>

Permit is not valid until all fees are paid in full, and shall be void if work is not started within six months of date above.

PAID
JUL 21 1982
CITY OF NAPOLEON

INSPECTION RECORD

UNDERGROUND		ROUGH-IN &			FINAL	
Type	Date	By	Type	Date	By	Date
PLUMBING	Sewer Connection		Drainage, W. & Vent			Drainage, W. & Vent
	Building Sewer		Water Piping			Water Heater
	Water Piping		Condensate Lines			Backflow Prevention
			Indirect Waste			
						FINAL APPROVAL
ELECTRICAL	Floor Ducts Raceways		Rough Wiring			Electric Mtr. Clearance
	Conduits & Cable		Conduits/Cable			Signs
	Grounding & Bonding		Service Panel Switchboard			
			Subpanels			
			<input type="checkbox"/> Range <input type="checkbox"/> Dryer			FINAL APPROVAL
MECHANICAL	Refrigerant Piping		Refrigerant Piping			Duct Insulation
	Ducts/Plenums		Ducts/Plenums			Chimney(s)
			Ventilation Supply			Furnace(s)
			<input type="checkbox"/> Exhst.			FINAL APPROVAL
			Wall Construction			Fireplace Chimney
BUILDING	Excavation		Crawl Space <input type="checkbox"/> Vent <input type="checkbox"/> Access			Attic <input type="checkbox"/> Vent <input type="checkbox"/> Access
	Footings & Reinforcing		Floor System(s)			Special Insp Reports Rec'd
	Sub-soil Drain		Roof System			Smoke Detector
	Foundation Walls		Fire Wall(s)			Demolition (sewer cap)
	Floor Slab		Roof Cover Roof Drain			Building or Structure
FINAL APPROVAL BLDG. DE		DATE	Certificate of Occupancy issued		#	

CITY OF NAPOLEON
BUILDING INSPECTION DEPARTMENT
APPLICATION FOR BUILDING PERMIT
(Please print or type)

The undersigned hereby makes application for construction, installation, or alteration work as herein specified, agreeing to do all such work in strict accordance with the City of Napoleon's adopted Building Codes.

Location of project 925 Welsted Cost of project \$ 160.

Owner's Name MARY LOU WINOVER Address MILINTA OHIO CO. ROAD

Contractor Lennie Winover Telephone No. None

Address 925 Welsted Napoleon Ohio

Lot Information: (Not required for siding job)

Lot No. _____ Subdivision _____

Zoning District _____ Lot Size 55 ft. X 390 ft. Area _____ sq. ft.

Setbacks: Front _____ Right Side _____ Left Side _____ Rear _____

Work Information:

Residential yes Commercial _____ Industrial _____

New Construction _____ Addition _____ Remodel yes

Accessory Building _____ Siding _____

Brief Description of Work: ----- move building 4000 feet
(Specific Type)

Size: Length 22' Width 10' No. of Stories one

Area: 1st Floor _____ sq. ft. Basement _____ sq. ft.

2nd Floor _____ sq. ft. Accessory Bldg. _____ sq. ft.

3rd Floor _____ sq. ft. Other _____ sq. ft.

Additional Information: _____

APPLICATION FOR PERMIT SHALL BE ACCOMPANIED BY TWO COMPLETE SETS OF PLANS INCLUDING: ELEVATIONS, FLOOR PLANS, CROSS SECTIONS AND PLOT PLAN. IF ADDITION OR REMODELING, SHOW ALL EXISTING STRUCTURES AND THEIR SIZE AND LOCATION. ALL PLANS SHALL BE DRAWN TO SCALE.

Date 7/20/82 Applicant's Signature Lennie Winover

PERMIT NO. 472
PERMIT FEE \$ 8.00

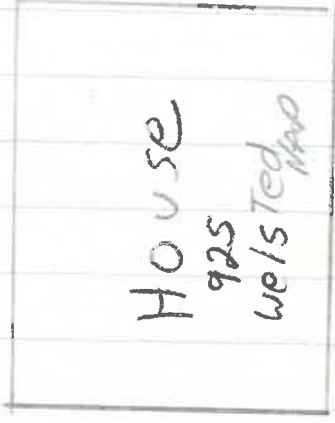

Move THE Building back 15'

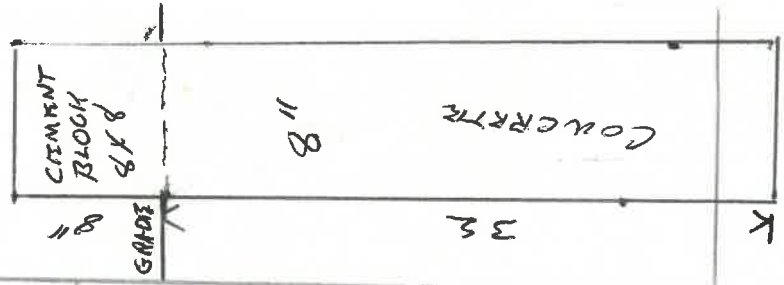

FOOTER

69'

55'

124'

ALL TOGETHER

925 WELSTED ROAD

ROAD

10/10/10

10/10/10



10/10/10

10/10/10



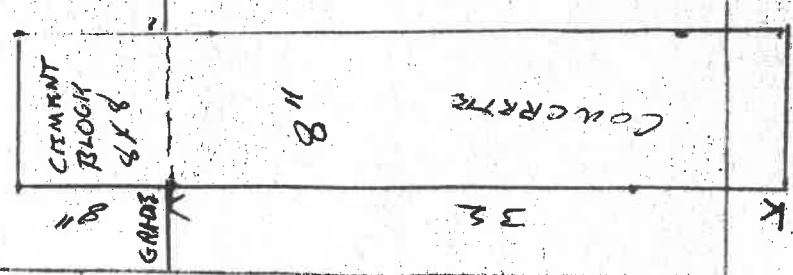
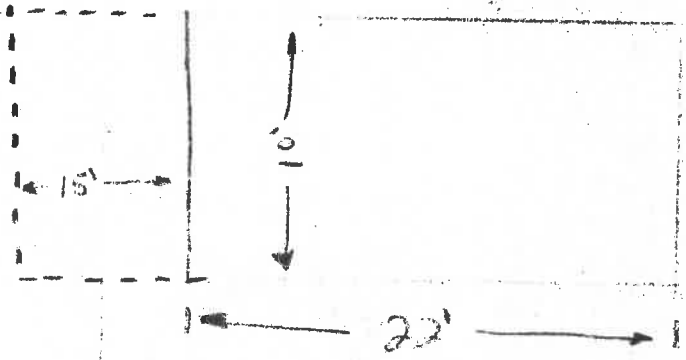
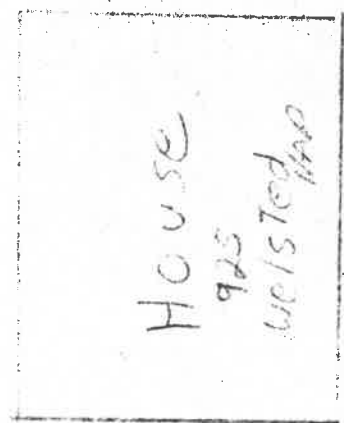
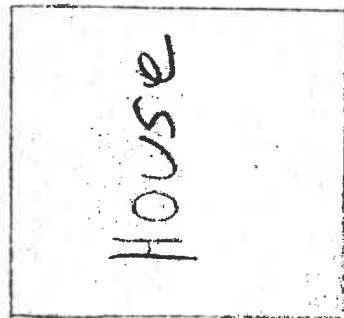
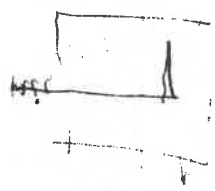

Move
THE
Building
Back 15'

FOOTER

124' ALTOURNA

55'

69'

925 WELSTRAD

ROAD

